



Pro Air WBS

SYSTEM TYPE: FLOATING



Wide body laminated sleepers and plywood provide the system with dimensional strength and stability

*Action Cush E
5/8" recycled rubber pad*

**MFMA NORTHERN HARD MAPLE
BY ACTION:**

Random Length (RL)
Action Long Length (FJ)

TESTING AGENCY:

Certified by ISSS

PERFORMANCE MEETS OR EXCEEDS:

EN 14904 Type 4
FIBA Level I
ASTM F2772

SLAB DEPRESSION:

25/32" (20 mm): 2-1/4" (57 mm)
33/32" (26 mm): 2-1/2" (63 mm)

LEED:

FSC Maple & Subfloor available, MR credits - based on products, selected materials and facility locations.

PERFORMANCE & SYSTEM STABILITY

- Factory fabricated sleeper system
- Exceptional playability and performance
- Low system profile height

- Action Pro Air WBS Floor system utilizes Action's recycled rubber pads resulting in a floor system with exceptional playability and performance.
- Factory fabricated wide body sleepers and ActionCush E pad construction keep profile height to a minimum.
- The manufacturer and flooring shall be independently verified by the guidelines of the ISO 14040-2006 and ISO 14044:2006 Life Cycle Assessment (LSA) confirming a negative carbon footprint.
- Carbon Evaluation must be inclusive and based on all corporate facilities, offices and mills
- The manufacturer and flooring shall be independently verified by the guidelines of the ISO 14040-2006 World Resource Institutes Greenhouse Gas Protocol, Scope 1, 2 and 3.
- The manufacturer and flooring shall be registered in the Collaborative for High Performance Schools (CHPS) Product Database.

Complete product specifications and system drawings (CAD and BIM) are available online at:

www.actionfloors.com

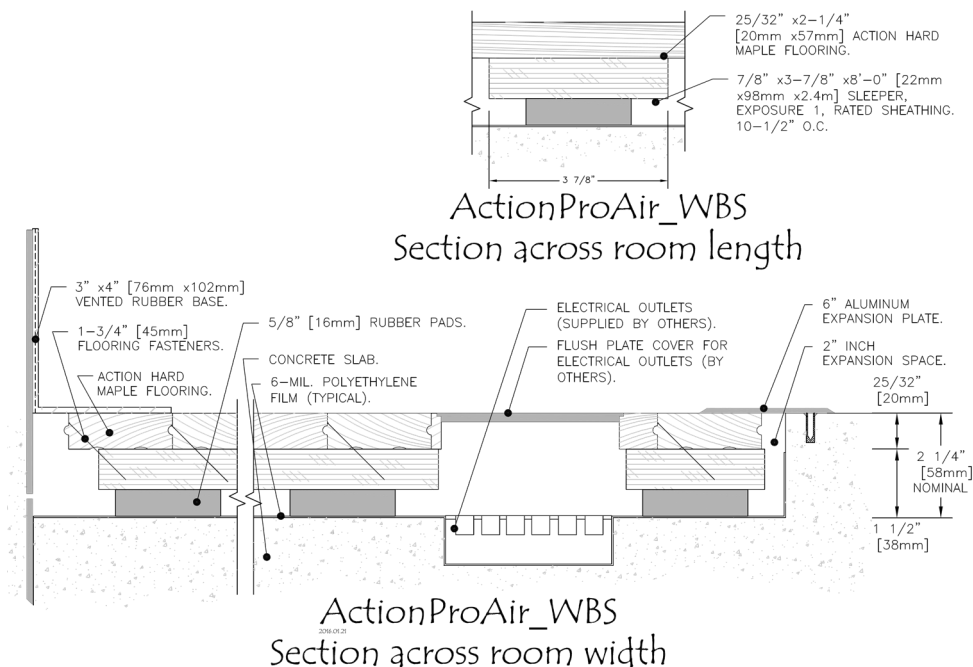

Action Pro Air WBS



ACTION FLOOR SYSTEMS LLC

4781 N. U.S. Hwy. 51 Mercer, WI 54547-9708 U.S.A

PHONE: 800-746-3512 or 715-476-3512 **FAX:** 715-476-3585

E-MAIL: info@actionfloors.com

www.actionfloors.com